



Quick Start Guide



BESS

For more Information: www.wiltec.hk Model No.: WT-0069

- Pack Contents**
- 1 BESS bottle warmer unit
 - 1 Baby food jar/feeding bottle support
 - 1 Quick Start Guide

2 APP

Install the “Warmer” APP on your Android Device, which can be found by scanning the QR code below.



NOTE: the “Warmer” APP supports only Android Device with Android 4.4.2 or above

3 SETTING UP BESS

Turning on BESS

Plug in power, “Link indicator” flashing in BLUE, means the unit has not connected with mobile app.

Press the On/off button to turn on the unit and the button flashing in AMBER.



In this stage, the unit is waiting for the user to select the temperature and bottle size.

Smartphone

Open the app on smartphone, it will display the Main Menu.

The APP will auto connect to bottle warmer unit.

If the Link indicator stop flashing and turn steady BLUE, the bottle warmer unit has connected with the mobile APP, and the link button on the app Main Menu disappeared.

If the Link indicator on bottle warmer unit keep flashing, press once the link button on the upper left corner of Main Menu.



! SAFETY INSTRUCTION

- This appliance can be used by children aged from 3 years and above if they have been given supervision or instruction concerning use of the appliance in a safe way and if they understand the hazards involved.
- Cleaning and user maintenance shall not be made by children unless they are older than 8 and supervised.
- Keep the appliance and its cord out of reach of children aged less than 8 years.
- Appliance can be used by persons with reduced physical , sensory or mental capabilities or lack of experience and knowledge if they have been given supervision or instruction concerning use of the appliance in a safe way and understand the hazards involved. Children shall not play with appliance.
- This appliance is intended to be used in household and similar applications such as:
 - staff kitchen areas in shops, officers and other working environments;
 - farm houses;
 - by clients in hotels. Motels and other residential type environments;
 - bed and breakfast type environment
- Appliance must not be immersed.
- Check food temperature not too hot (not over 37°C) before feeding.
- When not use the equipment, please unplug from the mains.

1 OVERVIEW

IMPORTANT NOTE

It is very important that you read the User Guide carefully as it contains detailed information. Please refer to the complete user manual which is available online at:

www.wiltec.hk

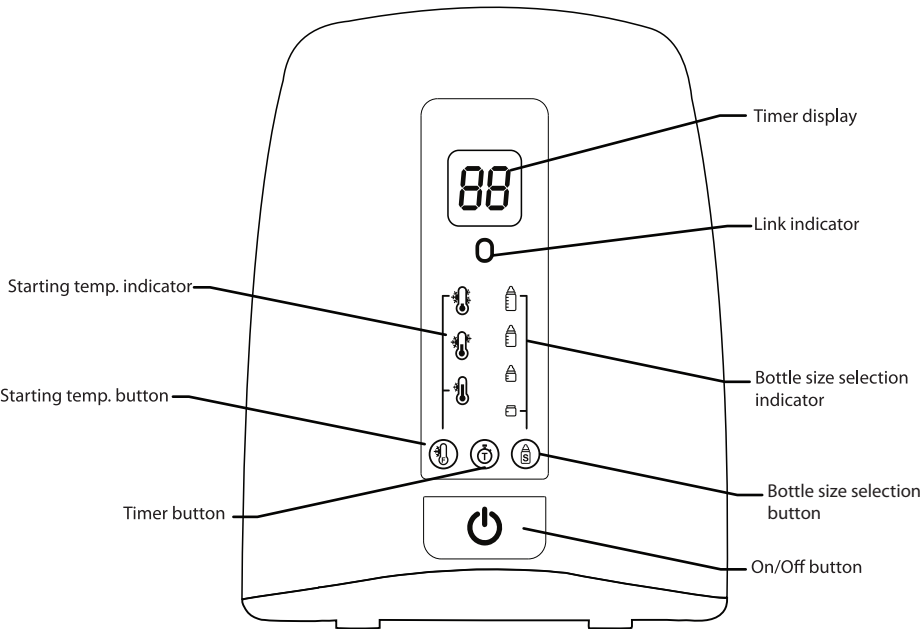

4 USING YOUR BESS

Before performing the steps illustrated below, make sure the power cord is unplugged from the mains socket.

1. Place the bottle warmer on a flat, level surface.

2. Pour water inside the main body as follows:

| | | Feeding Bottle (capacity) or jar | | | |
|----------------------|-------|------------------------------------|------------------------------------|-------------------------------------|---------------|
| | | Feeding bottle approx. 150 ml/5 oz | Feeding bottle approx. 250 ml/9 oz | Feeding bottle approx. 330 ml/11 oz | Baby food jar |
| Starting temperature | 20°C | 30 ml | | 60 ml | 80 ml |
| | 5°C | | | | |
| | -10°C | 60 ml | | 60 ml | |

3. Slowly insert the baby food jar/feeding bottle support inside the main body.

4. Plug in power. Press the On/off button to turn on the unit.

5. Select the type/capacity of the bottle to be warmed by pressing the Bottle size selection button until the AMBER LED is positioned on the desired option.



6. Set the starting temperature of the food by pressing the starting temp selection button until the AMBER LED is positioned on the desired option.



5 USING YOUR BESS

7 . Press the On/Off button again to start, it stop flashing and keep in AMBER and timer will be shown on the LCD.

| | | Feeding Bottle (capacity) or jar | | | |
|----------------------|-------|---------------------------------------|---------------------------------------|--|-----------------|
| | | Feeding bottle approx. 150 ml/5 oz | Feeding bottle approx. 250 ml/9 oz | Feeding bottle approx. 330 ml/11 oz | Baby food jar |
| Starting temperature | 20°C | 5 mins 15 secs | 5 mins 30 secs | 7 mins 20 secs | 6 mins 25 secs |
| | 5°C | 7 mins 00 secs | 8 mins 30 secs | 10 mins 40 secs | 8 mins 20 secs |
| | -10°C | 17 mins 25 secs | 17 mins 40 secs | 23 mins 00 secs | 19 mins 30 secs |

8. Upon finished heating, the ON/OFF button LED would be steady in GREEN.

9. After 3 minutes, the unit will go to standby mode. The ON/OFF button LED will flashing GREEN and LCD will turn OFF.

10. After use, press and hold the ON/OFF button LED for 3 seconds will switch the bottle warmer OFF

Using the schedule timer function

This feature can be used to warm-up the food in advance (up to 1 hour before).

- Press the timer button until you reach the time interval within which the contents should be ready. Time intervals: 15min, 30min, 45min, 60min.



- Press the ON/OFF button to start the selected heating mode.

- The LED on the ON/OFF button will go AMBER and blink until the actual warm-up cycle begins.

6 USING WITH SMARTPHONE

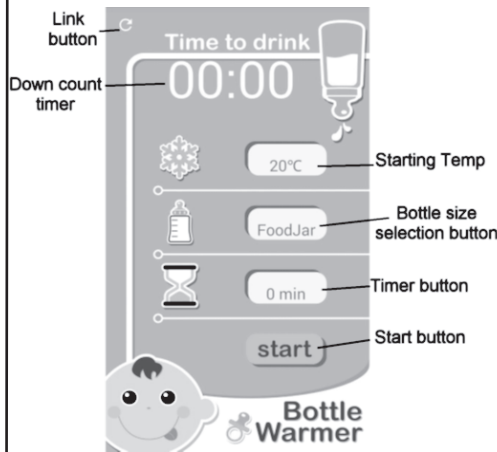

Set Starting Temp.

Set the starting temp of the food by pressing on the temperature selection icon on Main Menu then selection bar will be shown.



Select the desire starting temp by tapping on the selection bar.

Select bottle size

Select the bottle size by pressing on the bottle size selection icon on Main Menu. then selection bar will be shown.



Select the desire bottle size by tapping on the selection bar.

Set the schedule timer

Set the timer by pressing on the timer button on Main Menu then selection bar will be shown.



Select the time by tapping on the selection bar.

Start heating

Start the heating cycle by pressing on the Start button on Main Menu then timer display on Main Menu start showing the countdown.



And the On/Off button LED will be steady RED.

During heating, you can stop the heating at any time by tapping on the stop button.



In case of overheating, there will be warning message on smartphone. Bottle warmer unit will also generate warning tone.

Check the history record

You can check the heating history by tapping on the down count timer on the Main Menu.

Apps will show the history screen



TECHNICAL SPECIFICATION

BESS

Input: 220-240V~ 50/60Hz 170W
Transmission Frequency: 2400 - 2483.5MHz
Transmission power: 10dBm max

NOTE

Declaration of Conformity can be found on :
www.wiltec.hk/DOC



To access the user instruction online, use the reference model number written at the bottom of the Cover Page of this Quick Start Guide.

www.wiltec.hk

All rights reserved.

Wiltec HK Company Limited
Model : WT-0069

Made in China