



User Guide



BESS

For more Information:
www.wiltec.hk

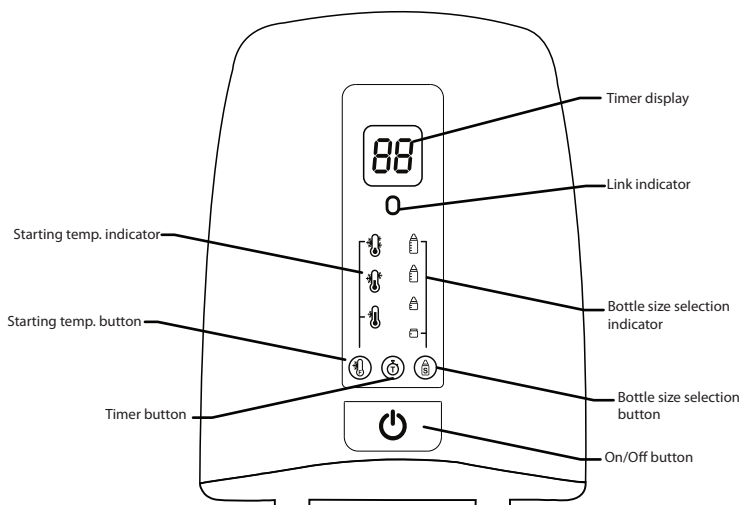

INTRODUCTION

Thank you for choosing BESS, the wise bottle warmer. This appliance is an electronic wireless communication system that allows you warm your baby food easily with or without your Android smartphone via Bluetooth.

Please retain your original dated sales receipt for your records. For warranty service of your Wiltec product, you will need to provide a copy of your dated sales receipt to confirm warranty status.

Registration is not required for warranty coverage.

For product related questions, please contact the shop or agent you purchased Wiltec product.

This User Guide provides you with all the information you need to get the most from your product.

Before you can use the bottle warmer, we recommend you fully charge the battery of your smartphone, so that it continues to work if you disconnect it from the power supply to carry it to another location.

Please read the Safety Instructions on page 3 before you install the units.

PACK CONTENTS

- 1 BESS bottle warmer unit
- 1 Baby food jar/feeding bottle support
- 1 Quick Start Guide

WARNING

- Always make sure that electrical appliances and their wires are kept out of children's reach.
- The appliance's range varies according to the obstacles it meets (lie of the land, number of partition walls between the transmitter and the receiver, the presence of metal structures, etc.).
- Please read all the instructions carefully before you use the product.
- Keep the appliances well away from all sources of heat (maximum 40°C) and humidity.
- Check regularly that the product is working properly.
- Clean the appliance with a soft, dry cloth. Do not immerse it in water or expose it to water drops or splashes.
- The appliance should not be dropped or subjected to violent impacts.
- Do not place sources of naked flames, such as lit candles, on the appliance.
- To avoid all risk of electrocution, do not expose the appliance to rain or damp conditions.
- This appliance is intended to be used in household and similar applications such as:
 - staff kitchen areas in shops, offices and other working environments;
 - farm houses;
 - by clients in hotels. Motels and other residential type environments;
 - bed and breakfast type environment

WARNING

- The electricity supply switch should be easily accessible.
- Test this product and all its functions so that you are familiar with it prior to actual use.
- Do not touch the plug contacts with sharp or metal objects.
- This appliance can be used by children aged from 3 years and above if they have been given supervision or instruction concerning use of the appliance in a safe way and if they understand the hazards involved.
- Cleaning and user maintenance shall not be made by children unless they are older than 8 and supervised.
- Keep the appliance and its cord out of reach of children aged less than 8 years.
- Appliance can be used by persons with reduced physical , sensory or mental capabilities or lack of experience and knowledge if they have been given supervision or instruction concerning use of the appliance in a safe way and understand the hazards involved. Children shall not play with appliance.
- Appliance must not be immersed.
- Check food temperature not too hot (not over 37°C) before feeding.
- When not use the equipment, please unplug from the mains.
- Do not move the product during use.
- Plug this appliance into a wall socket easily reachable by an adult but out of reach of children.
- Do not cover the appliance with a cloth or other objects (fire hazard).
- Do not handle the appliance with moist or wet hands.
- In the case of failure do not try to open or repair the appliance since it does not contain parts that can be repaired or replaced by the user.

ATTENTION!

TO REDUCE THE RISK OF ELECTRIC SHOCK, DO NOT REMOVE THE PROTECTION OR ATTEMPT TO OPEN THE PRODUCT.
DO NOT EXPOSE TO HUMIDITY OR ATTEMPT TO OPEN THEM.
THIS MAY BE A SOURCE OF DANGER AND SHALL VOID THE WARRANTY.

SETTING UP BESS

Turning on BESS

Plug in power, “Link indicator” flashing in blue, means the unit has not connected with mobile app.

Press the On/off button to turn on the unit and the button flashing in AMBER.



In this stage, the unit is waiting for the user to select the temperature and bottle size.

Smartphone

Install the “Warmer” APP on your Android Device, which can be found by scanning the QR code below with a 3rd party APP.



Note that the “Warmer” APP only support Android Device with Android 4.4.2 or above. If your device has system lower than that, please update it to Android 4.4.2 or above.

SETTING UP BESS

Smartphone

Open the APP on smartphone, it will display the Main Menu.

The APP will auto connect to bottle warmer unit.

If the Link indicator stop flashing and turn steady blue, the bottle warmer unit has connected with the mobile APP, and the link button on the app Main Menu disappeared.

If the Link indicator on bottle warmer unit keep flashing, press once the link button on the upper left corner of Main Menu.



USING YOUR BESS

Before performing the steps illustrated below, make sure the power cord is unplugged from the mains socket.

1. Place the bottle warmer on a flat, level surface.
2. Pour water inside the main body as follows:

		Feeding Bottle (capacity) or jar			
		Feeding bottle approx. 150 ml/5 oz	Feeding bottle approx. 250 ml/9 oz	Feeding bottle approx. 330 ml/11 oz	Baby food jar
Starting temperature	20°C	30 ml		60 ml	80 ml
	5°C				
	-10°C	60 ml		60 ml	

3. Slowly insert the baby food jar/feeding bottle support inside the main body.
4. Plug in power. Press the On/off button) to turn on the unit.
5. Select the type/capacity of the bottle to be warmed by pressing the Bottle size selection button until the AMBER LED is positioned on the desired option.



6. Set the starting temperature of the food by pressing the starting temp selection button until the AMBER LED is positioned on the desired option.



USING YOUR BESS

7. Press the On/Off button again to start, it stop flashing and keep in RED and timer will be shown on the LCD.

		Feeding Bottle (capacity) or jar			
		Feeding bottle approx. 150 ml/5 oz	Feeding bottle approx. 250 ml/9 oz	Feeding bottle approx. 330 ml/11 oz	Baby food jar
Starting temperature	20°C	5 mins 15 secs	5 mins 30 secs	7 mins 20 secs	6 mins 25 secs
	5°C	7 mins 00 secs	8 mins 30 secs	10 mins 40 secs	8 mins 20 secs
	-10°C	17 mins 25 secs	17 mins 40 secs	23 mins 00 secs	19 mins 30 secs

8. Upon finished heating, the On/Off button LED would be steady in GREEN.

9. After 3 minutes, the unit will go to standby mode.

The ON/OFF button LED will flashing GREEN and LCD will turn OFF.

10. After use, press and hold the On/Off button LED for 3 seconds will switch the bottle warmer off

Using the schedule timer function

This feature can be used to warm-up the food in advance (up to 1 hour before).

- Press the timer button until you reach the time interval within which the contents should be ready.

Time intervals: 15min, 30min, 45min, 60min.



- Press the On/Off button to start the selected heating mode.

- The LED on the On/Off button will go AMBER and blink until the actual warm-up cycle begins.

USING YOUR BESS WITH SMARTPHONE

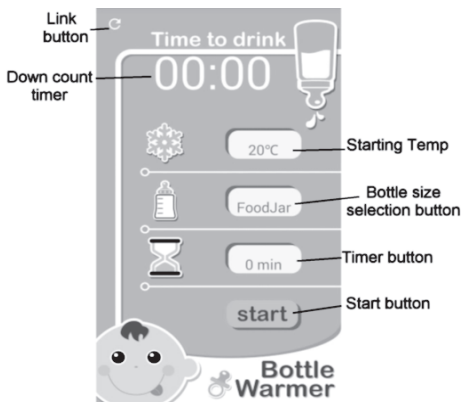

Set Starting Temp.

Set the starting temp of the food by pressing on the temperature selection icon on Main Menu then selection bar will be shown.



Select the desire starting temp by tapping on the selection bar.

USING YOUR BESS WITH SMARTPHONE

Select bottle size

Select the bottle size by pressing on the bottle size selection icon on Main Menu.

then selection bar will be shown.



Select the desire bottle size by tapping on the selection bar.

USING YOUR BESS WITH SMARTPHONE

Set the schedule timer

Set the timer by pressing on the timer button on Main Menu then selection bar will be shown.



Select the time by tapping on the selection bar.

USING YOUR BESS WITH SMARTPHONE

Start heating

Start the heating cycle by pressing on the Start button on Main Menu then timer display on Main Menu start showing the countdown.



And the On/Off button LED will be steady AMBER.

During heating, you can stop the heating at any time by tapping on the stop button.



In case of overheating, there will be warning message on smartphone.

Bottle warmer unit will also generate warning tone.

USING YOUR BESS WITH SMARTPHONE

Check the history record

You can check the heating history by tapping on the down count timer on the Main Menu.

Apps will show the history screen

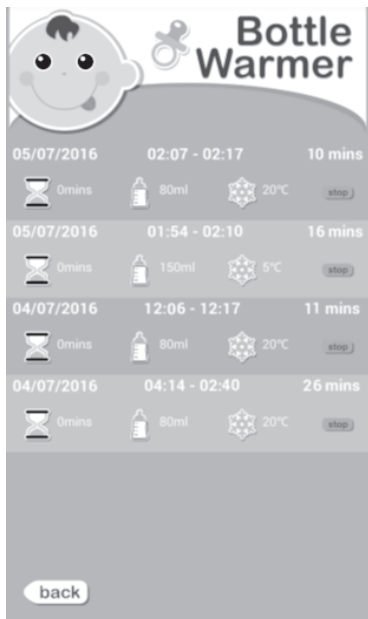

TECHNICAL SPECIFICATION

BESS

Input : 220-240V~ 50/60Hz 170W

Transmission Frequency: 2400 - 2483.5MHz

Transmission power: 10dBm max

Declaration of Conformity

Hereby, Wiltec declares that Wise Bottle Warmer is in compliance with the essential requirements and other relevant provisions of Directive 1999/5/EC.

The Declaration of Conformance for Wise Bottle Warmer is available from:
www.wiltec.hk/DOC

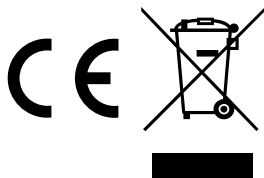

All rights reserved.

Wiltec HK Company Limited
Model : WT-0069

Made in China